

## AMI-II Trides

Continuous and reagent-free disinfectant monitoring. Foremost the free chlorine concentration is critical for meeting existing water quality regulations and control water treatment processes. With the AMI-II Trides, Swan sets the highest standard for a comprehensive, reliable measurement. The optional pH/Redox measurement does ensure pH compensation for even more accurate results.



### AMI-II Transmitter

- Robust, large backlit display
- Easy to understand menu guidance
- All measuring values at a glance
- Storage of calibration history

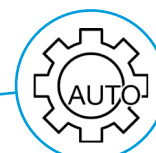

### Optional: Relay Box

Two additional relays to control dosing pumps, valves and other actuators

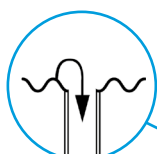

### Constant Head

This sample overflow cell eliminates sample pressure and sample flow fluctuations to ensure highly accurate measurements

- Add an optional pH sensor
- Add an optional Redox sensor

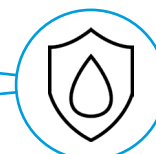

### Optional: Cleaning Module III

User installable pump on the panel

Ready-to-use solutions for:

- Anti-scaling
- Sensor fouling prevention
- Zero-chlorine cross-checks

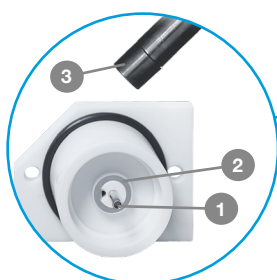

### 3 Electrode System

Consists of two platinum electrodes <sup>1 2</sup> and one reference electrode <sup>3</sup>

Very low operating costs:

- No membranes
- No electrolytes
- No periodic replacements of spare parts



### Sensor Rotor

- Continuous, automatic mechanical sensor cleaning minimizes maintenance work
- Sample flow and cleaning efficiency are continuously monitored



### Grab Sampling

Fully integrated needle valve for easy quality control of online measurements

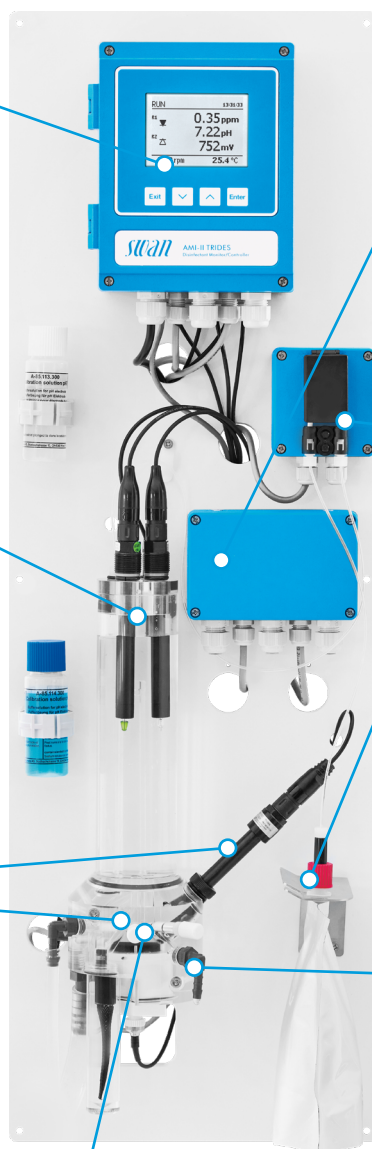

## AMI-II Trides Product Line



AMI-II Trides

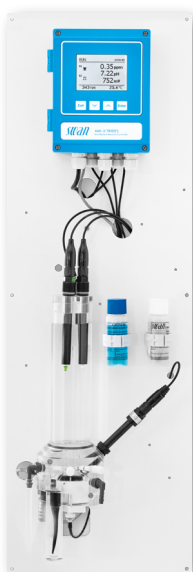

with SS pH, Redox



with SS pH, Redox,  
Relay Box



with SS pH, Redox,  
CM-III P



with SS pH, Redox,  
CM-III P, Relay Box



Cleaning Modul-III  
(CM-III)

## Accessories



**pH Sensor**  
A-87.127.030



**Cleaning Module-III P**  
A-82.311.010



**Relay Box**  
A-89.812.200



**Redox Sensor**  
A-87.427.030



**Oxycon Clean Solutions**  
A-85.81x.xx0



**Buffer Solutions  
(pH 7 and 9)**  
A-85.119.010

## Range of Applications

The AMI-II Trides is the ideal solution wherever accuracy, cost-efficiency, and reliability are essential.

In potable water, it ensures microbiological safety while controlling taste, odor, and disinfection by-products—and can also verify chlorine-free water quality.

In pool systems, it continuously maintains optimal hygiene levels, preventing both under- and overdosing of disinfectants for safe and balanced operation.

In industrial water applications, the AMI-II Trides safeguards processes, equipment, and product quality through precise control of disinfection in cooling, reuse, and wastewater systems.

It is equally well suited for food and beverage applications, where reliable disinfection is critical to ensuring hygiene, safety, and consistent production standards.